

ASSEMBLY INSTRUCTIONS
SPACER DAMPER NUTCRACKER TYPE
AI 454

1. Check the article number of the product and compare the conductor range with the conductor being used.
2. Turn all orange locking pins in order to open the clamps
3. Check if there are two insert rubbers in each clamp
4. Put the spacer damper into the bundle from above and make sure that the clamps catch the sub-conductors. The correct orientation of the spacer damper “↑UP” is marked on the main frame.

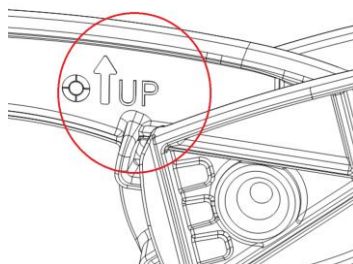

5. Check that the head of the orange locking pin is in its correct position (parallel to the slot and perpendicular to the conductor) so it will fit through the slot of the clamp keeper.

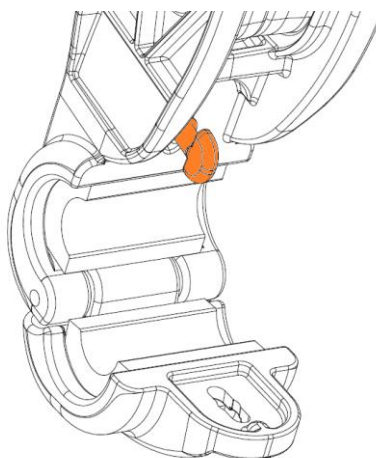

6. Position the sub-conductor into the insert rubber of the clamp body and close the clamp by hand. Push the clamp together with hand force and maintain pressure.

REV.		21-11-2016 / BUP 24.05.2016 / ELH	LANGUAGE		PAGE
			EN		1 of 3

SPACER DAMPER NUTCRACKER TYPE

AI 454

7. Take the PFISTERER mounting tool and put it into place: The pressure-body should touch the surface on the clamp between the pin and the frame above the clamp. The catcher should be put in the catcher hole underneath the clamp. The lever should be parallel to the conductor and perpendicular to the spacer damper. Keep the hand pressure on the clamp during this process.

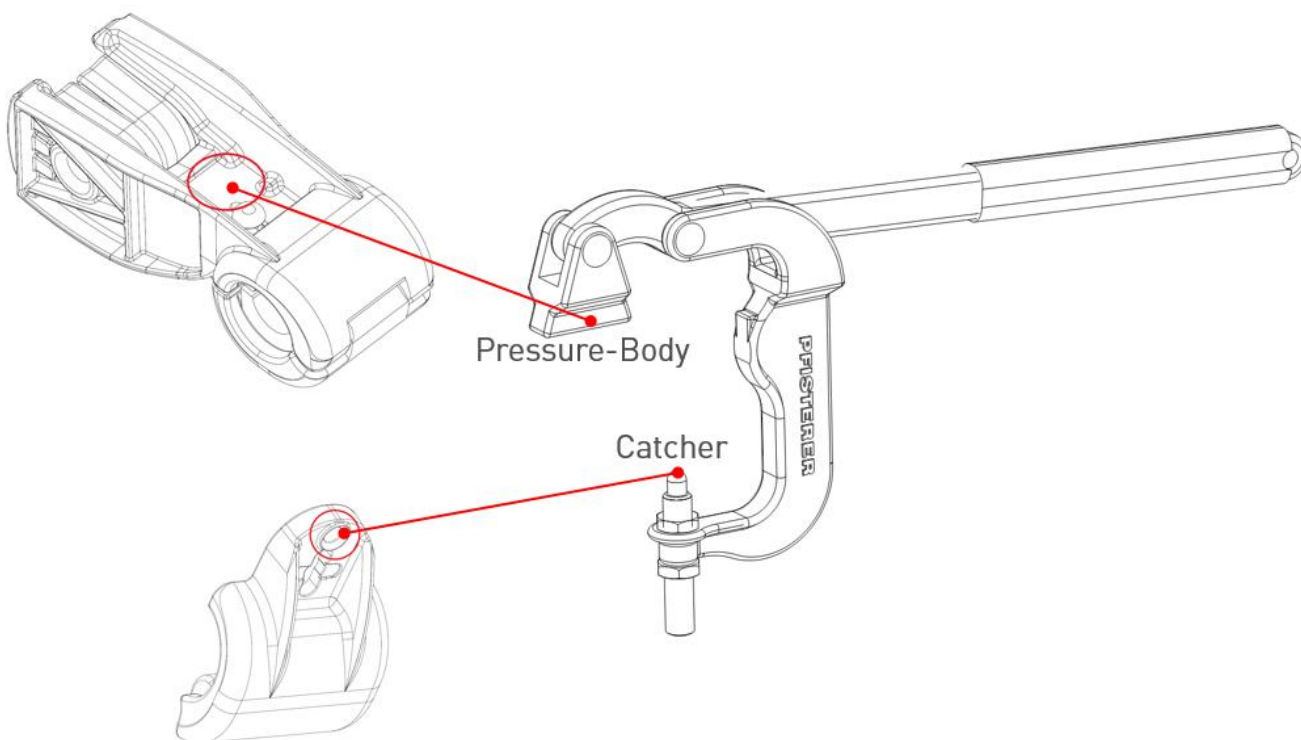

8. Move the lever of the mounting tool up. This will require some force. In the upright position, the lever will snap in a stable position.

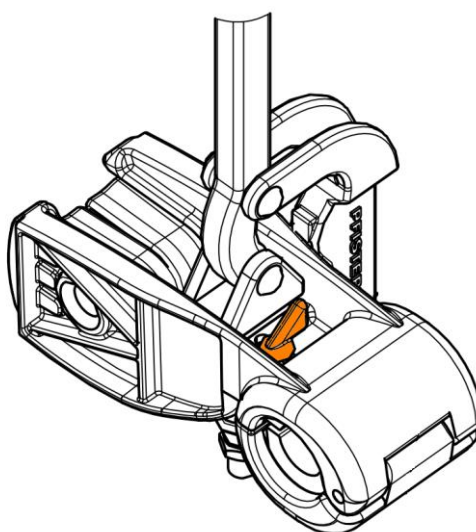

REV.	-	21-11-2016 / BUP	LANGUAGE	PAGE
	A	24.05.2016 / ELH		
			EN	2 of 3

ASSEMBLY INSTRUCTIONS

SPACER DAMPER NUTCRACKER TYPE

AI 454

- Grab the head of the orange locking pin and turn it 90 degree, so it touch the pressure body of the mounting tool. Keep your hand at the orange locking pin.

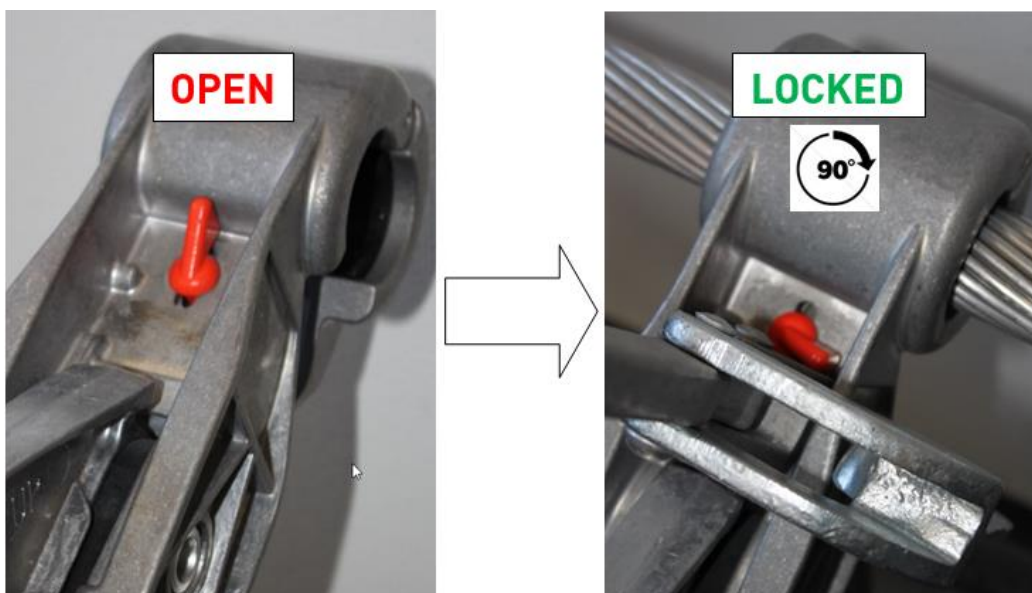

- Move the leaver of the mounting tool back to its initial position parallel to the conductor, to release the force. And put away the mounting tool
- Check that the head of the orange locking pin is in its correct position (parallel to the slot and perpendicular to the conductor) so it will fit through the slot of the clamp keeper.

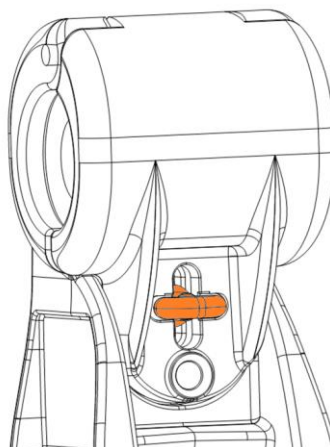

- If yes, installation is completed.

REV.		21-11-2016 / BUP 24.05.2016 / ELH		LANGUAGE	PAGE
				EN	3 of 3